

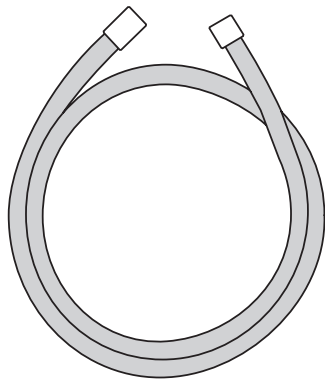



# AXOR

- DE / Montageanleitung  
FR / Instructions de montage  
EN / Assembly instructions  
IT / Istruzioni per Installazione  
ES / Instrucciones de montaje  
NL / Handleiding  
DK / Monteringsvejledning  
PT / Manual de Instalação  
PL / Instrukcja montażu  
CS / Montážní návod  
SK / Montážny návod  
ZH / 组装说明  
RU / Инструкция по монтажу  
HU / Szerelési útmutató  
FI / Asennusohje  
SV / Monteringsanvisning  
LT / Montavimo instrukcija  
HR / Uputstva za instalaciju  
TR / Montaj kılavuzu  
RO / Instrucțiuni de montare  
EL / Οδηγία συναρμολόγησης  
SL / Navodila za montažo  
ET / Paigaldusjuhend  
LV / Montāžas instrukcija  
SR / Uputstvo za montažu  
NO / Montasjeveiledning  
BG / Инструкция за употреба  
UA / Інструкція по збірці  
AR / تعليمات التجميع  
JP / 施工説明書  
HE / הוראות הרכבה



- AXOR Starck  
28282XXX (1,25 m)  
28284XXX (2,00 m)  
28286XXX (1,60 m)  
AXOR  
28622XXX (1,25 m)  
28624XXX (2,00 m)  
28626XXX (1,60 m)

INSTALLATION

	P	max. 0,6 MPa 6 bar	0 - 0,4 MPa 0 - 4 bar	
	T	max. 60 °C	< 50 °C	

Classification acoustique  
et débit: NF

Test certificate: DVGW CQ0363

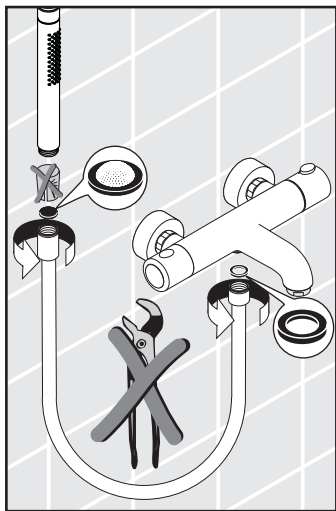

AXOR / Hansgrohe SE  
Austraße 5-9  
77761 Schiltach  
Deutschland

info@AXOR-design.com  
AXOR-design.com